



# WORMADALE HOUSING DEVELOPMENT



**3 x SINGLE STOREY 2 BEDROOM HOUSES**



**Within easy reach of Lerwick.  
Now complete and available for  
immediate entry**

## **Location**

The properties are situated approximately 10 miles north-west of Lerwick in the attractive setting of Wormadale which lies at the head of Whiteness Voe.

The location means the town is within easy commuting distance by car or by bus as Westside bus services run along the main westside road a short distance from the site.

Amenities in the immediate area include a local shop less than a mile away, a primary school about a mile further on, and a second shop with post office & fuel, at Weisdale, a mile past the school.

# Overview of Floor plan and Outside area

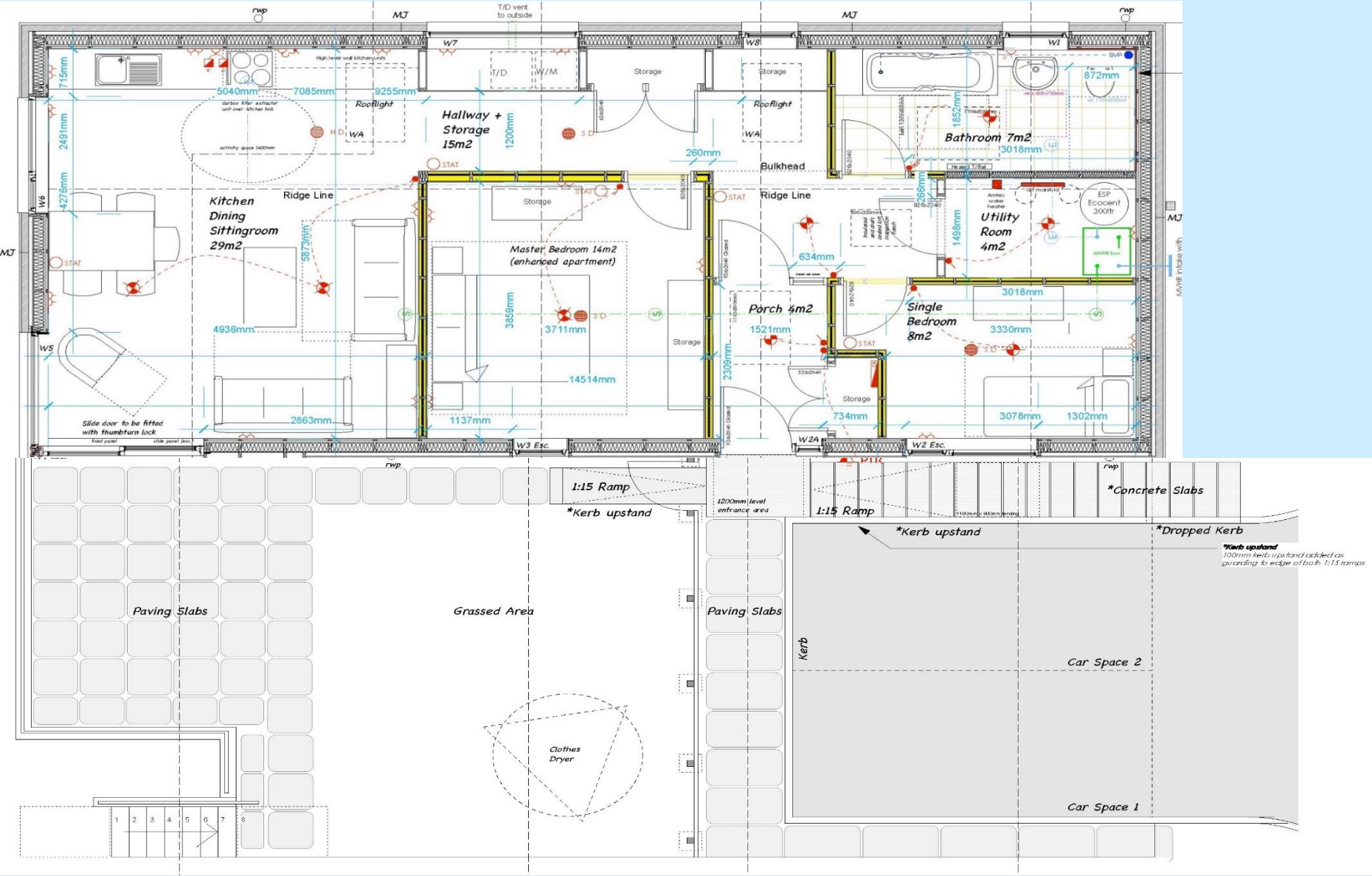

Floor plans courtesy of Richard Gibson Architects



**For further details please contact  
Roy Leask/Peter Tait  
Tel: 01595 692733 or  
email [Office@ditt-shetland.co.uk](mailto:Office@ditt-shetland.co.uk)**

## Property description

**Masonry clad, with wooden larch features , timber frame construction, with double glazed windows & doors, decra tiled roof and whole house ventilation heat recovery system. The interior comprises of an open plan living space with patio doors, 2 bedrooms, separate bathroom facility, and fitted kitchen, featuring units in a contemporary gloss finish with wood effect worktop.**



## External grounds

**The parking area is tarred, with garden ground turfed and seeded, with ample area to house a small DITT shed if required. Spacious paved patio area, with sufficient room for garden furniture to enjoy the peaceful surroundings.**